

Soils Map

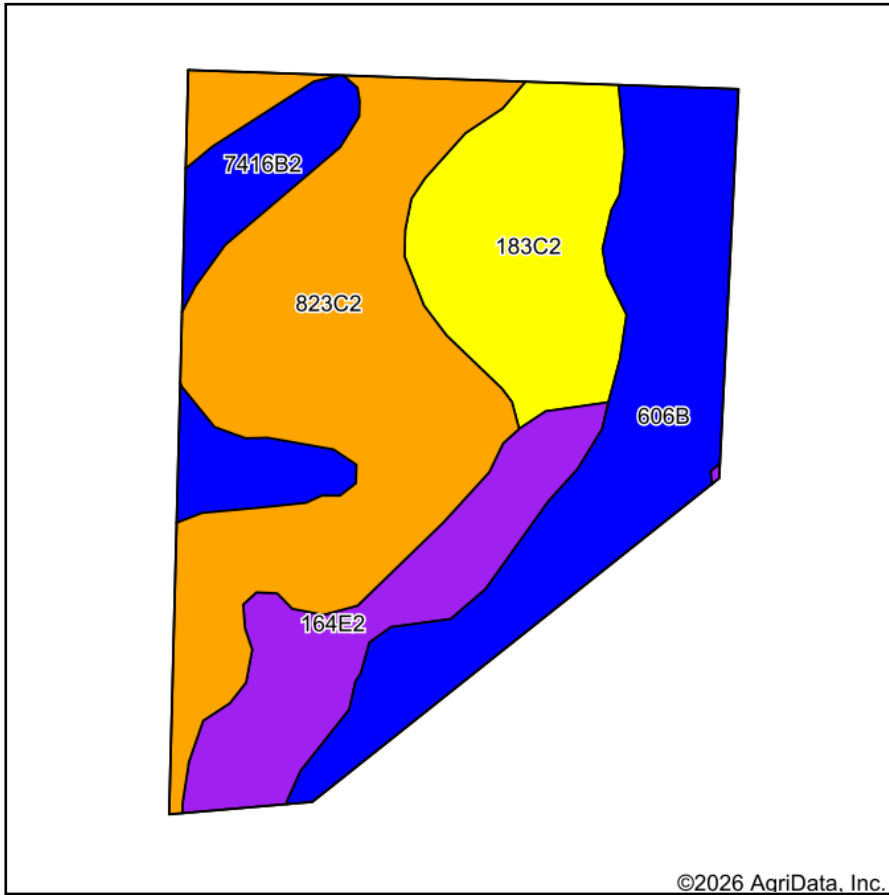

Soils data provided by USDA and NRCS.

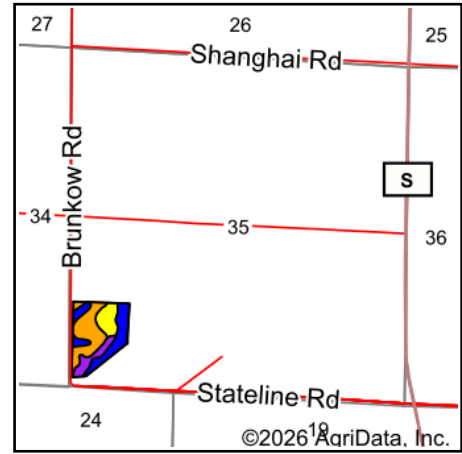

State: **Wisconsin**
 County: **Green**
 Location: **35-1N-8E**
 Township: **Jefferson**
 Acres: **19.27**
 Date: **4/8/2026**

Maps Provided By:

 CUSTOMIZED ONLINE MAPPING
 © AgriData, Inc. 2025 www.AgriDataInc.com



Area Symbol: WI045, Soil Area Version: 26

Code	Soil Description	Acres	Percent of field	Non-Irr Class Legend	Non-Irr Class *c	Alfalfa hay Tons	Corn Bu	Corn silage Tons	*n NCCPI Overall	*n NCCPI Corn	*n NCCPI Small Grains	*n NCCPI Soybeans
823C2	Whalan silt loam, 6 to 12 percent slopes, moderately eroded	7.17	37.2%		IIIe	3.6	90	15	64	64	57	55
606B	Huntsville silt loam, 2 to 6 percent slopes, rarely flooded	4.55	23.6%		Ile	5	138	23	80	80	73	76
183C2	Edmund silt loam, 6 to 12 percent slopes, moderately eroded	3.23	16.8%		IVe	2.6	70	11	46	46	37	31
164E2	Sogn silt loam, 12 to 30 percent slopes, moderately eroded	2.60	13.5%		VIIIs	1.3	40	6	31	31	23	21
7416B2	Durand silt loam, 2 to 6 percent slopes, moderately eroded	1.72	8.9%		Ile	4.9	130	21	77	77	66	66
Weighted Average					3.38	3.6	94.8	15.5	*n 61.5	*n 61.5	*n 53.6	*n 52.3

*n: The aggregation method is "Weighted Average using all components"

*c: Using Capabilities Class Dominant Condition Aggregation Method

Soils data provided by USDA and NRCS.