

Soils Map

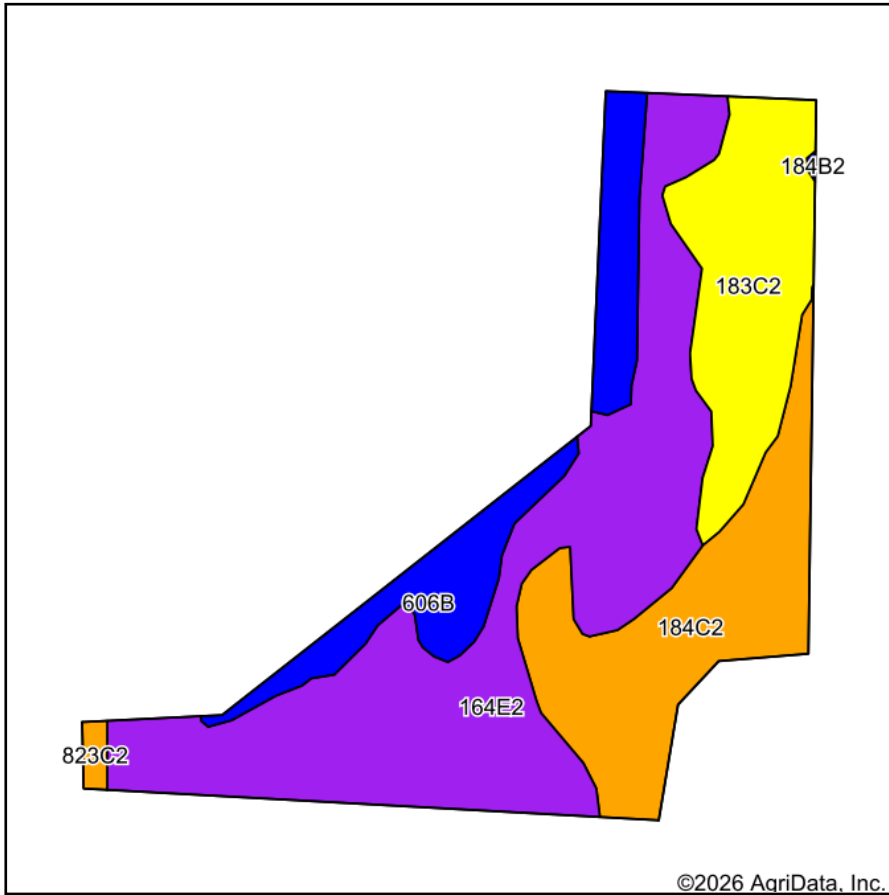

Soils data provided by USDA and NRCS.

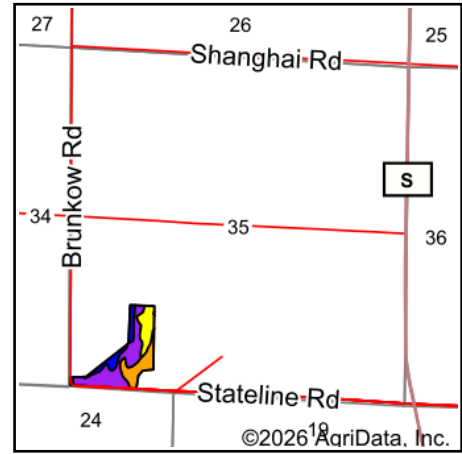

State: **Wisconsin**
 County: **Green**
 Location: **35-1N-8E**
 Township: **Jefferson**
 Acres: **17.37**
 Date: **4/4/2026**



Area Symbol: WI045, Soil Area Version: 26

Code	Soil Description	Acres	Percent of field	Non-Irr Class Legend	Non-Irr Class *c	Alfalfa hay Tons	Corn Bu	Corn silage Tons	*n NCCPI Overall	*n NCCPI Corn	*n NCCPI Small Grains	*n NCCPI Soybeans
164E2	Sogn silt loam, 12 to 30 percent slopes, moderately eroded	8.01	46.1%		Vlls	1.3	40	6	31	31	23	21
184C2	Dodgeville silt loam, 6 to 12 percent slopes, moderately eroded	3.86	22.2%		Ille	4.1	110	18	62	62	57	48
183C2	Edmund silt loam, 6 to 12 percent slopes, moderately eroded	3.06	17.6%		IVe	2.6	70	11	46	46	37	31
606B	Huntsville silt loam, 2 to 6 percent slopes, rarely flooded	2.32	13.4%		Ile	5	138	23	80	80	73	76
823C2	Whalan silt loam, 6 to 12 percent slopes, moderately eroded	0.12	0.7%		Ille	3.6	90	15	64	64	57	55
Weighted Average					4.89	2.7	74.3	11.9	*n 47.3	*n 47.3	*n 39.9	*n 36.3

*n: The aggregation method is "Weighted Average using all components"

*c: Using Capabilities Class Dominant Condition Aggregation Method